

WATSON

INDUSTRIAL PARK CHINO

310,100 SF

Available For Lease

36' Clear Height for up to 25% more storage space



Content Subject to Change

Legacy BuildingSM 838

8721 Merrill Avenue, Chino, CA



Build Green. Everyone Profits.

LEED- Leadership in Energy & Environmental Design

Legacy BuildingSM 838 has been constructed as a LEED[®] certified building. LEED[®] developments are voluntary and are designed to be environmentally responsible, high performing, sustainable and healthy places to work.

*LEED is a registered trademark of the U.S. Green Building Council.

SPECIFICATIONS

BUILDING SIZE: 310,100 SF

OFFICE SIZE: 0,000 SF

LAND SIZE: 688,713 SF

TRUCK POSITIONS: Dock High: 57 (9' x 10')
Ground Level Ramp: 1 (12' x 14')

TRUCK TURNING RADIUS: Up to 185'

MINIMUM CLEARANCE: 36'

SPRINKLER SYSTEM: ESFR

TRAILER STORAGE SPACES: 72

POWER: 1,200 amps, 277/480 volts,
3 phase, 4 wire

PARKING SPACES: 220

LEGACY FEATURES

100% concrete truck courts

3% skylights

Architectural two-story glass entries

8" thick reinforced, 4,000 psi
concrete floor slabs

Abundant clerestory glass



WATSON

INDUSTRIAL PARK CHINO

310,100 SF

Available For Lease



OFFICE PLAN 0,000 SF



LEGACY BUILDINGSM 838 SITE PLAN

LEED[®] Certified

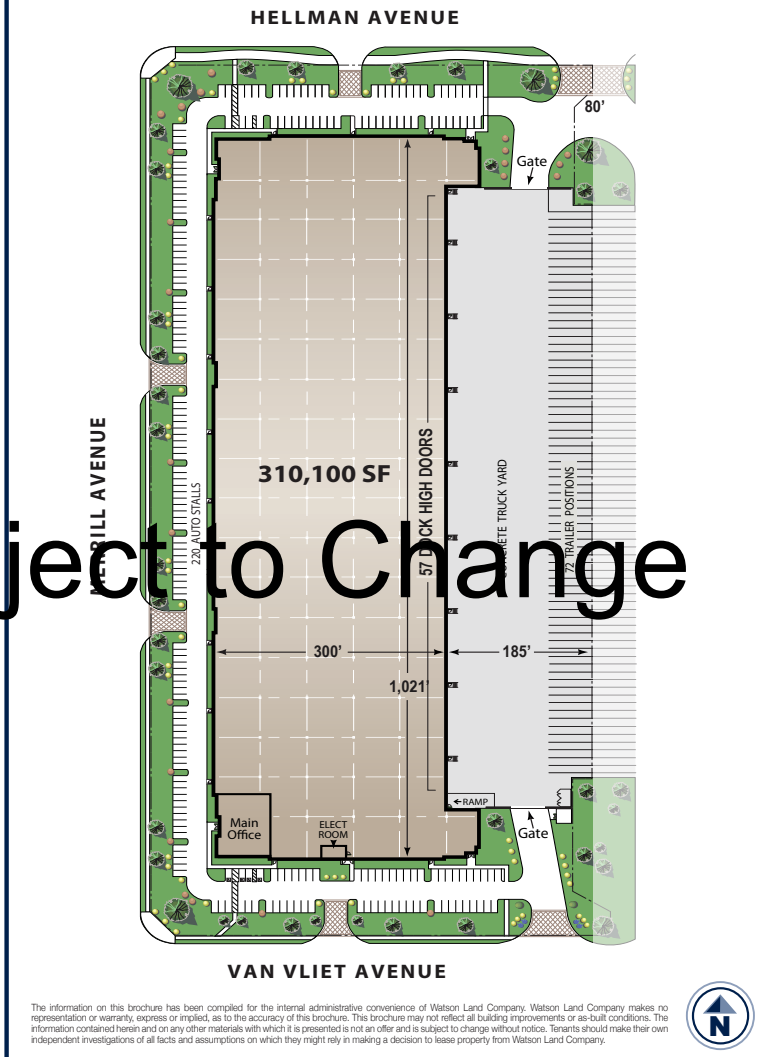

Content Subject to Change

WATSON INDUSTRIAL PARK CHINO

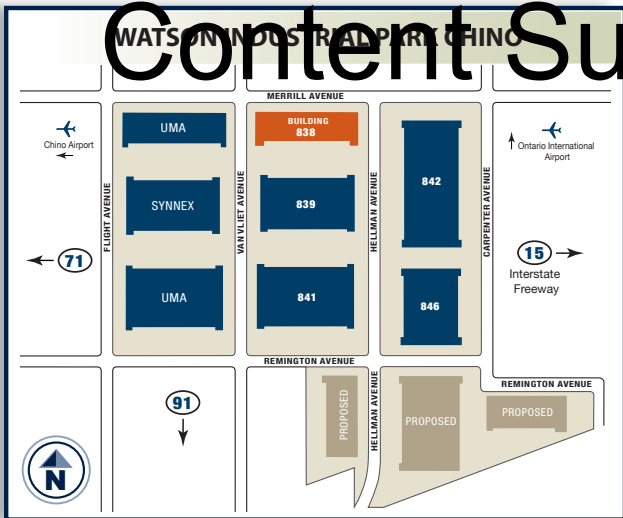

For Further Information Please Contact:

Thomas E. Taylor
 thomas.taylor@colliers.com
 License # 00598896

Steven J. Bellitti
 steve.bellitti@colliers.com
 License # 01048797

Josh Hayes
 josh.hayes@colliers.com
 License # 01300731

Summer Coulter
 summer.coulter@colliers.com
 License # 01811350



Our Knowledge is your Property

COLLIERS International
 2855 E. Guasti Road
 Suite 401
 Ontario, CA 91761
 colliers.com

Ph 909.860.3180
 Fax 909.396.4300
 watsonipc.com